

# WAGO Wire and Cable Marking

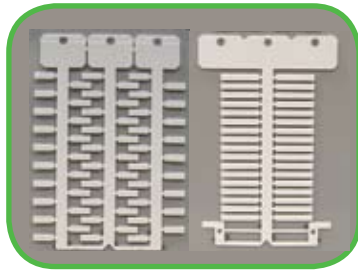

The following marker cards are available:  
Marker cards for plotter marking...



...or marker cards on roll for thermal transfer printing



Remove the thermal transfer printed marker card from the roll...



...and slide it through the marker receptacle up to the end of the sleeve...



...then remove the rest of the card by twisting it off



Fix the marking sleeve 211-129 using cable ties to individual wire or cable



Changing the marking is also possible after the wire has been connected

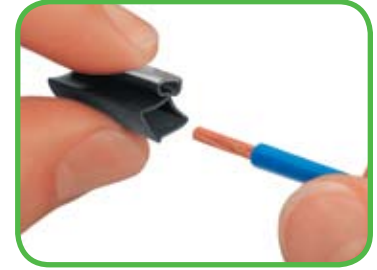

Compress the sleeve and slide it onto the wire to be marked

## Cable Marking



Self-laminating labels are available on A4 sheets for the laser printer (plotter)...



...or are supplied on roll for the thermal transfer printer



Remove the printed label from the sheet or roll...



...and wrap it around the wire or cable



The transparent laminate protects the marking



Wire and Cable Marking Options:	
Marker Card for Plotter	<b>211-110</b> (12mm) <b>211-120</b> (23mm)
Plotter Receptacle for marker card	<b>258-370</b>
Marker Card for Thermal Transfer Printer (TP298, TP343)	<b>211-111</b> (12mm) <b>211-121</b> (23mm)
Marking Sleeve (12mm)	<b>211-112</b> <b>211-113</b> <b>211-114</b> <b>211-114</b> For various diameters of wire
Marking Sleeve (23mm)	<b>211-122</b> <b>211-123</b> <b>211-124</b> <b>211-125</b> For various diameters of wire
Marking Sleeve for cable tie (23mm)	<b>211-129</b>
Marker Labels on DIN A4 Sheets for Laser Printer or Plotter	<b>211-150</b> <b>211-151</b>
Marker Labels on roll for Thermal Transfer Printer (TP298)	<b>211-155</b> <b>211-156</b>
Heat Shrink Tubing on a continuous reel can also be printed on using our Thermal Transfer Printers.	

For more information about these products, consult the catalogs or website.